

HAMMER MILL

FEATURES

- Heat treated hammers
- Modular design
- Silent and vibration free operation (90-93 dbA)
- Minimum aspiration requirement
- High efficiency
- Ease of operation and maintenance
- Easy to operate and compact design
- A wide range of capacities
- Maximum flexibility and versatility
- Quality and proven performance
- Spare parts support and customer service
- Low investment, operation and maintenance costs

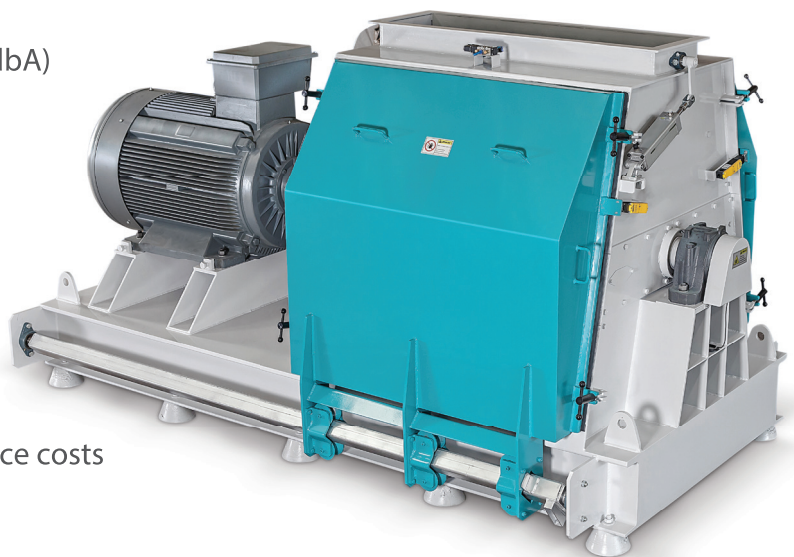

LIVESTOCK



POULTRY



RENDERING



FOOD



BIOMASS



CHEMICALS

 **YEMMAK**

HAMMER MILL UNIT

Yemmak hammer mill is constructed as a single unit consisting of a base frame with mill housing, rotor for hammers, side doors with screen frames and direct coupled electric motor. With its robust structure and a construction that need low maintenance, these machines offer high efficiency.

Rotor of the mill has been balanced at the maximum working speed. Natural magnetic rotary feeder provides operating safety.

The raw material to be grinded is sent to the mill by the rotary feeder. The mill is suitable to work in both directions. The right combination hammer units, sieve diameter and rotation speed, provides high efficiency grinding.

AREAS OF USAGE

- Feed mills
- Food and oil extraction plants
- Chemical plants



Technical Drawing - 1

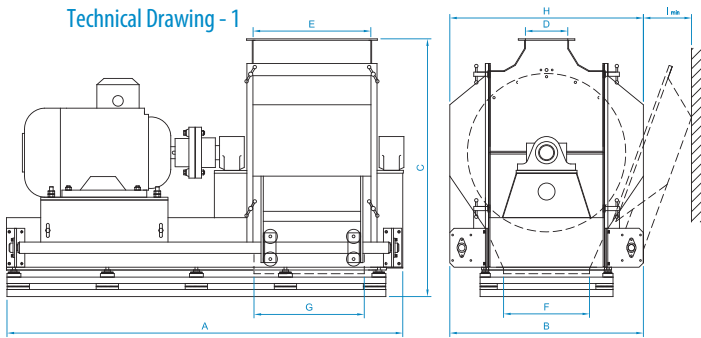

Technical Drawing - 2

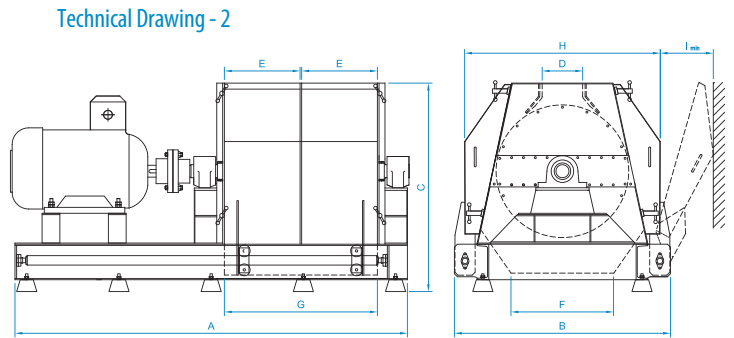

	MODEL	KAPASİTE* (ton/h)	MOTOR (kW)	SCREEN AREA (dm ²)	AMOUNT OF AIR NEEDED FOR ASPIRATION (m ³ /min)	DIMENSIONS (mm)								
						A	B	C	D	E	F	G	H	I (min)
Technical Drawing - 1	GHM 1120/400	5-10	90-110	100	62	1840	1380	1840	305	405	610	380	1380	500
	GHM 1120/500	10-15	110-132	135	78	2080	1380	1840	305	505	610	480	1380	500
	GHM 1120/600	15-20	132-160	160	94	2350	1380	1840	305	605	610	580	1380	500
	GHM 1120/700	20-25	160-185	190	110	2450	1380	1840	305	705	610	680	1380	500
	GHM 1120/800	25-30	185-200	210	125	2785	1380	1840	305	805	610	780	1380	500
Technical Drawing - 2	GHM 1120/1000	30-40	200-225	260	156	3150	1860	1850	350	550	870	1100	1650	500
	GHM 1120/1200	40-50	250-315	320	187	3310	1860	1850	350	650	870	1300	1650	500

* Corn, with Ø3 mm screen

JET FILTER

The most important thing in the mill units is using a suitable jet filter to ensure a quality grinding and a high performance mill.

Jet filter's filtering surface is chosen according to the screen area and the amount of air needed for aspiration. There is an aspiration fan system which vacuums the air from the filter clothing. The fan helps the dust to be kept by dedicated polyester filter cloths with needles.

The dust attached to the clothing is cleaned by the pulse valves on top of the air bottles that is connected to the jet filter body, and the dust is embodied in the system.



SERVO FEEDER

It is used in the grinding processes, for the grinder to provide the maximum efficiency at the requested capacity. Due to the homogeneous flow, the grinding hammers work at the longest duration and the highest efficiency. The magnet that the grinder has for working safely, holds the metal pieces with its magnet. These pieces of metal are cleaned automatically and falls to the drawer underneath it.

FEATURES

- Product diffuser and flow control rotor
- Metal trapping magnet
- Speed controlled drive system
- Automatic metal cleaning system
- Adjustable air intake channels
- Observation glasses and inspection hatch

AREAS OF USAGE

- It is used on grinding lines before Hammer Mill and Roller Mill.

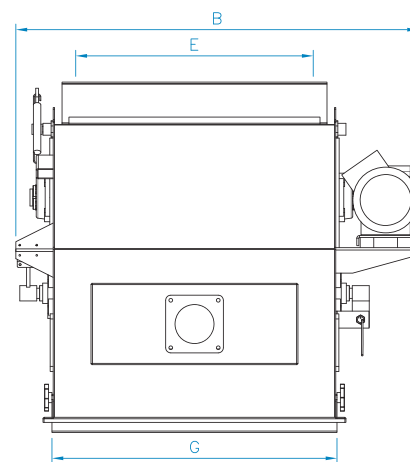
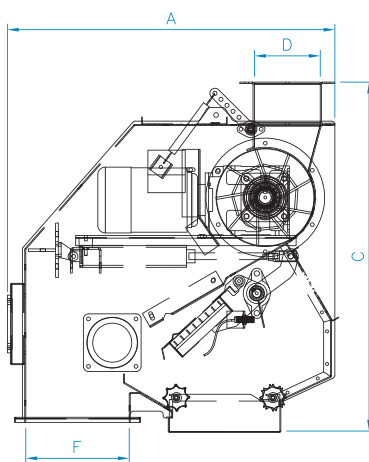

MODEL	MOTOR (kW)	DIMENSIONS (mm)						
		A	B	C	D	E	F	G
SF 400	1,1	965	800	1000	200	295	305	430
SF 500	1,1	965	900	1000	200	395	305	530
SF 600	1,5	965	1000	1000	200	495	305	630
SF 700	1,5	965	1100	1000	200	595	305	730
SF 800	1,5	965	1200	1000	200	695	305	730
SF 1000	2,2	965	1500	1000	200	1000	355	1130
SF 1200	2,2	965	1600	1000	200	1200	355	1230

